

# BEA

Design: Doriana e Massimiliano Fuksas

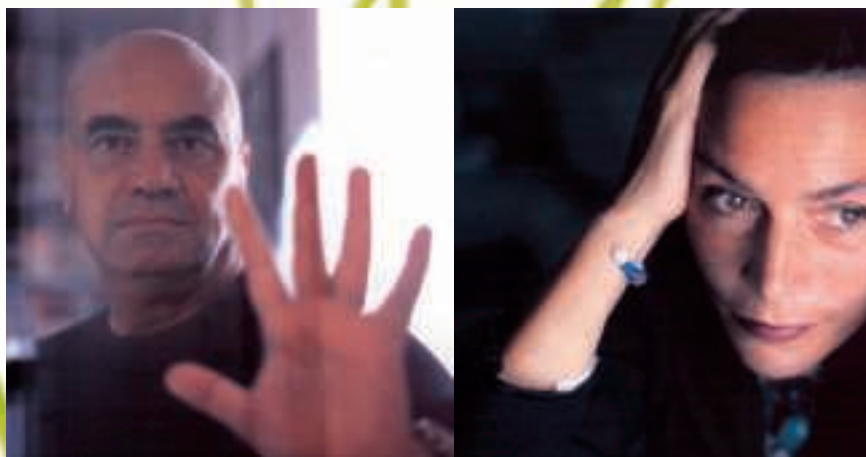

Ph: Maurizio Marcatò



Design: Doriana e Massimiliano Fuksas



(look-see

Recent Projects 2000 - 2005

Ferrari Product Development Center, Maranello  
Twin Towers, Wien, Austria  
Mall, entertainment Centre, Europark, Salzburg  
Research and Multimedia Centre - Grappa Nardini,  
Bassano del Grappa, Vicenza  
New Congress Hall, Rome  
New trade fair, Milano  
New Concept for Emporio Armani, Hong Kong, China  
New Concept for Emporio Armani, Shanghai, China  
Piazza Mall, Entertainment centre, commercial and  
office complex, Eindhoven, Holland

Twin Towers, Wien AUSTRIA

Admirant. Shops, Casino, Restaurant, Eindhoven, Netherlands

New Trade Fair Milan

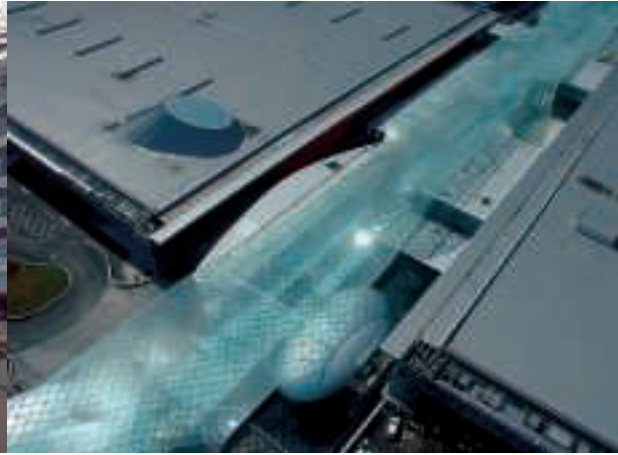

phook-sus)

Bea is New Concept.

Instead of articulating all ergonomic technology by exposing an exo-skeleton, like much of recent office seating solutions, Bea incorporates all in its flexible and sensual shell.

In its loaded version, it includes the strictest ergonomic and safety standards (EN, ANSI-BIFMA), while in its non-work versions it becomes a residential lounge chair.

An internal frame in Zytel® 80G33 is covered with double layer of reinforced Pebax®, using the same technology and materials utilized to make athletic footwear. Housed in its task intensive model is a BeaRevo synchron mechanism with push & click controls, armrests are adjustable in height and inclination, lumbar adjustment, and forward seat slider. Upholstered in flame-retardant anti-transpiration fabrics.



Bea è un nuovo concept.

Invece di esporre tutta la tecnologia ergonomica rendendo visibile strutture tipo esoscheletro, come molte recenti sedute, Bea incorpora tutto nel suo guscio flessibile e sensuale.

Nella sua versione più lavorativa include le più esigenti norme di sicurezza ed ergonomia (EN, ANST-BIFMA), mentre nelle sue versioni extra-lavoro diventa una sedia per la casa.

Un telaio interno in Zytel® 80G33 è coperto da una doppia guaina di Pebax® caricato, utilizzando la stessa tecnologia e materiali delle calzature sportive. Nella sua versione più operativa sono inglobate: meccanica synchro BeaRevo comandata da pulsanti push&click, regolazione lombare, traslatore avanzato sedile, braccioli regolabili in altezza ed inclinazione. Sedile e schienale rivestiti con tessuti ignifughi ed antitranspirazione.



Fukas progetti recenti 2000 - 2005

Ferrari Product Development Center, Maranello  
 Twin Towers, Wien, Austria  
 Mall, entertainment Centre, Europark, Salzburg  
 Research and Multimedia Centre - Grappa Nardini,  
 Bassano del Grappa, Vicenza  
 New Congress Hall, Rome  
 New trade fair, Milano  
 New Concept for Emporio Armani, Hong Kong, China  
 New Concept for Emporio Armani, Shanghai, China  
 Piazza Mall, Entertainment centre, commercial and  
 office complex, Eindhoven, Holland

Research and Multimedia Centre - Grappa Nardini,  
Bassano del Grappa, Vicenza





New Trade Fair Milan



New Concept for Emporio Armani Hong Kong, China



New Concept for Emporio Armani, Hong Kong, China



New Congress Hall, Rome



Mall, entertainment Centre, Europark, Salzburg

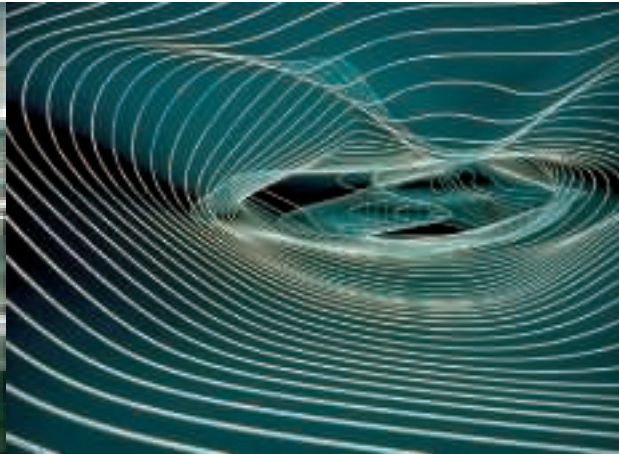





## BEA instruction manual

Bea has 7 push-and-click button controls to adjust its ergonomic setup.

on the left side of the seat

1. forward seat slider adjustment;
2. synchron lock/unlock inclined positions

on the right side of the seat

3. vertical height adjustment column gas lift;
4. tension adjustment to body weight;
5. lumbar support height adjustment;

under each armrest

- A. armrest height adjustment
- B. armrest angle adjustment

Bea dispone di 7 pulsanti push-&-click per regolare il suo assetto ergonomico.

sul lato sinistro del sedile

1. regolazione traslatore sedile avanzato;
2. blocco/sblocco synchro a posizioni inclinazione;

sul lato destro del sedile

3. regolazione in altezza colonna a gas;
4. regolazione tensione al peso corporeo;
5. regolazione altezza supporto lombare;

sotto ogni bracciolo

- A. regolazione altezza braccioli;
- B. regolazione inclinazione braccioli

under each armrest  
sotto ogni bracciolo



A

A. armrest height adjustment;  
A. regolazione altezza braccioli;

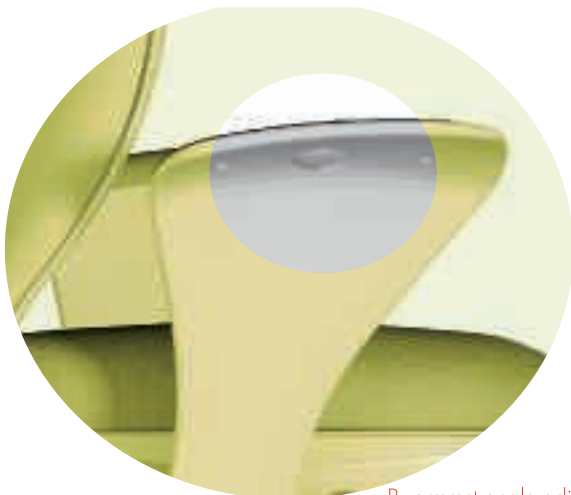

B

B. armrest angle adjustment;  
B. regolazione inclinazione braccioli;





on the left side of the seat  
sul lato sinistro del sedile

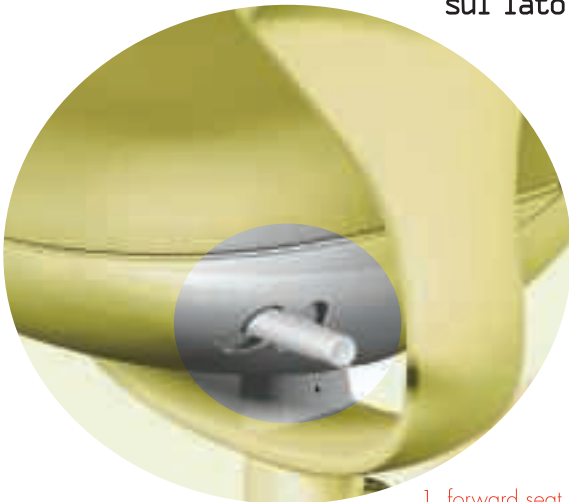

1

1. forward seat slider adjustment;  
1. regolazione traslatore sedile avanzato;

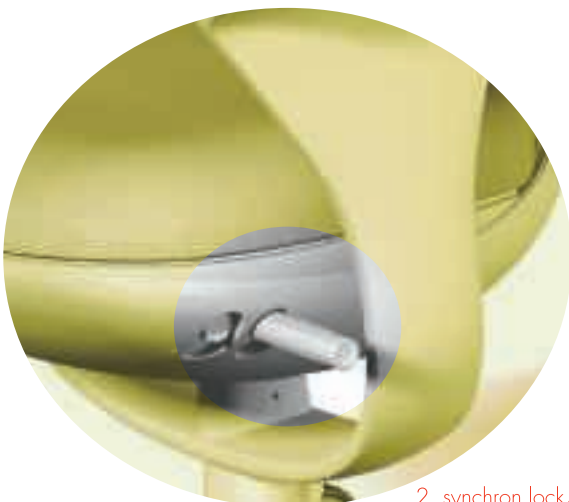

2

2. synchron lock/unlock inclined positions;  
2. blocco/sblocco synchro a posizioni inclinazione;



on the right side of the seat  
sul lato destro del sedile



3

3. vertical height adjustment column gas lift;  
3. regolazione in altezza colonna a gas;

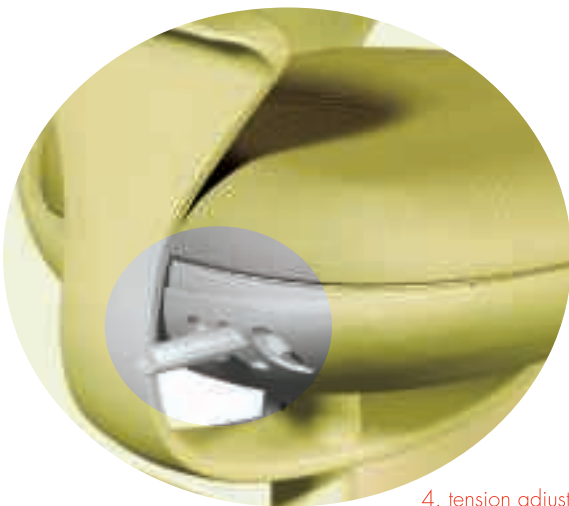

4

4. tension adjustment to body weight;  
4. regolazione tensione al peso corporeo;

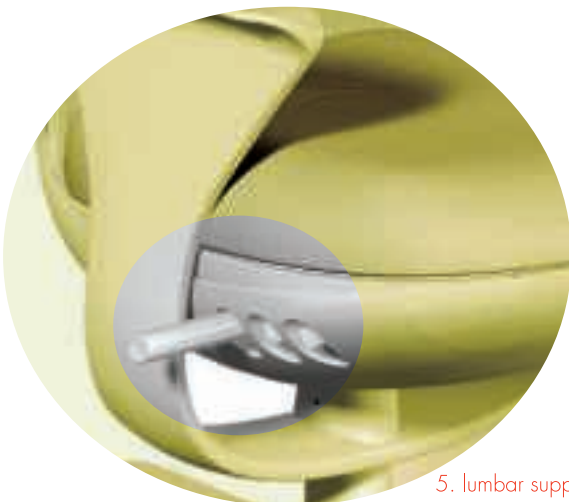

5

5. lumbar support height adjustment  
5. regolazione altezza supporto lombare





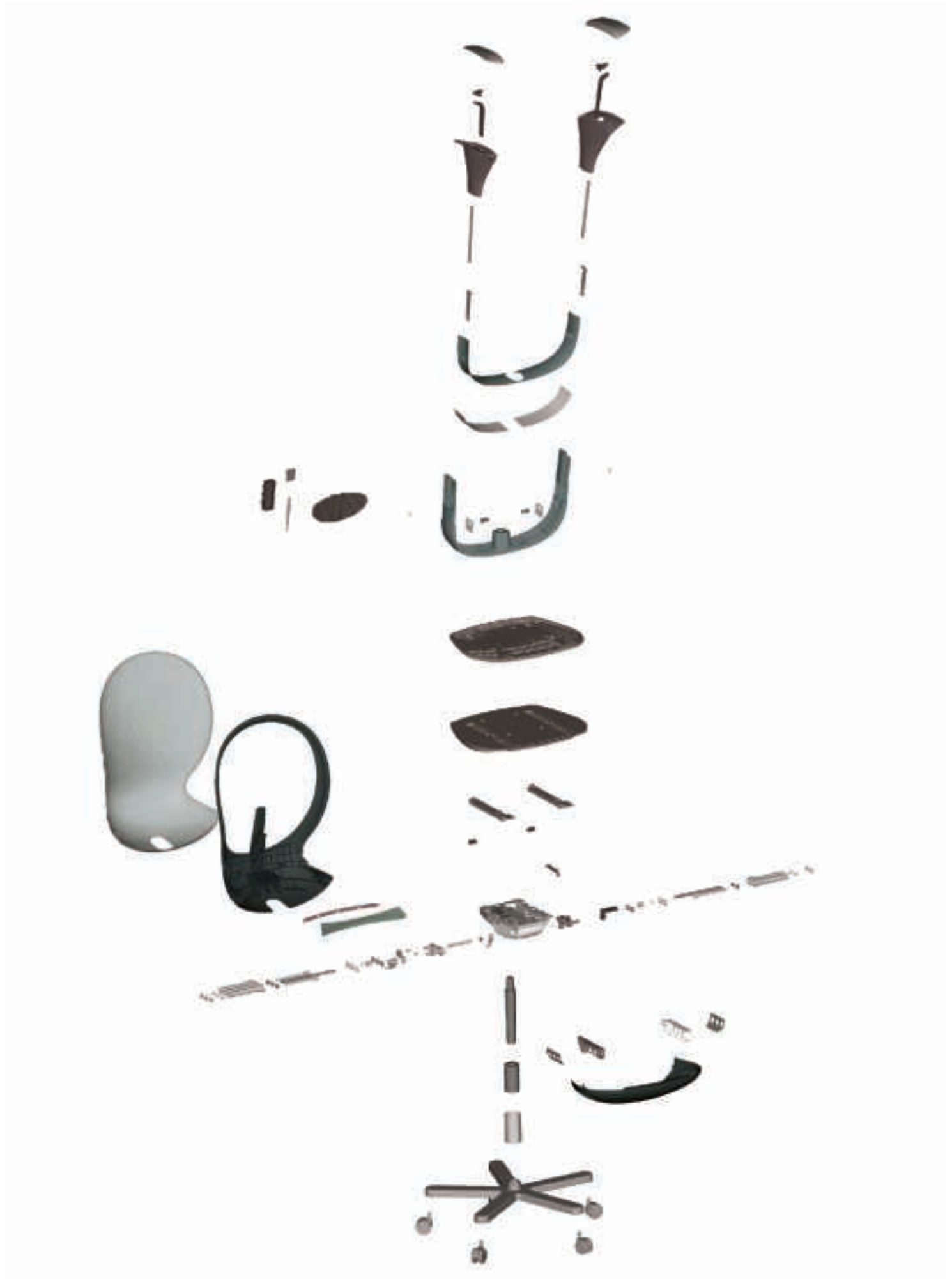

## BEA facts

object: New Concept

name: Bea

typology : task intensive ergonomic

n° components project: 87

materials: polypropelene, nylon+fg, aluminum,  
steel, flame retardant foam, flame retardant fabrics

mechanism: push-button BeaRevo synchron

launch: April 2006

delivery: September 2006

oggetto: New Concept

nome: Bea

n° componenti progetto: 87

materiali: polipropilene, nylon +fv, alluminio, acciaio,  
gomma ignifuga, tessuti ignifughi

meccanismo: BeaRevo synchron a pulsanti

introduzione: Aprile 2006

consegne: Settembre 2006

Design: Doriana e Massimiliano Fuksas

Partner in Charge: Doriana O. Mandrelli

Fuksas office: Davide Stolfi  
Ana Gugic  
Thomas Bernschein

Bea Team  
Coordination  
& Engineering: Stefano Getzel  
Luigi Cappellin



New Concept for Emporio Armani, Hong Kong, China

New trade fair, Milano

Research and Multimedia Centre - Grappa Nardini, Bassano del Grappa, Vicenza

Ferrari Product Development Center, Maranello



LU-BE4-0306

Render Imaging: Renderstudio (VI)

Reproductions: Elektronograph (VR)

Print: Se.Graf (PD)

A.D.: Getzel Design Studio (VI)

Printed in Italy: 03/06



**LUXY**®

**LUXY** S.R.L. Via Melaro, 6 36041- Alte di Montecchio Magg. (Vicenza) - ITALY  
Tel. ++39/0444/696111 Fax ++39/0444/694163 E-Mail: luxy@luxy.com

[www.luxy.com](http://www.luxy.com)

Certified Quality System UNI EN ISO 9001:2000

