



*Classic. Modern. The Hennen Cross ceiling fixture from David Weeks Studio.*

**spencer  
interiors**

# Hennen Cross

## TECHNICAL SPECIFICATIONS

No. 432

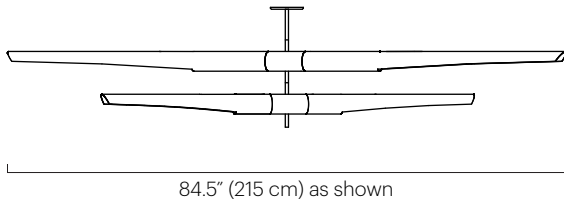

11.5" (29 cm)

84.5" (215 cm) as shown

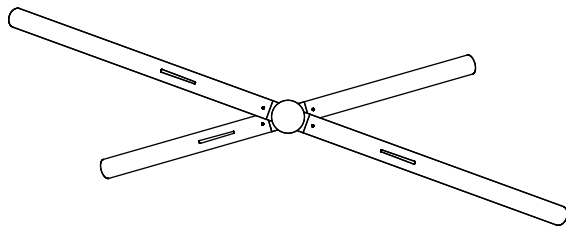

32.5" (83 cm) as shown



### Description

Expanded to any angle from their symmetrical axis, the tiers of the Hennen Cross provide an expansive reach. Tiers are configured with large or small shades that can be set to cast light up or down. Additional tiers can be added, and any combination of large and small tiers can be specified.

### Materials

Shades: Powder coated aluminum  
Frame: Plated steel & aluminum  
Ceiling mount: Powder coated steel  
Drop: Plated steel rod

### Shade Color

○ White Gloss (white gloss interior)

Custom colors available.

### Finish

● Polished Nickel

### Lamping (per tier)

US/Canada: (2)T10 tubular incandescent 60W max  
Europe: (2)E27 base (tubular 32mm suggested) 60W max  
Note: Bulbs not included.  
Halogen bulbs not recommended.

### Wattage

120 watts max per tier

### Weight

Weight varies; depends on number of tiers and dimensions.  
2-tier fixture: approx 15 lbs (7 kg)

### Remarks

Specify drop length.  
Fixed drop not adjustable on site.  
Two tier minimum.  
Specify tier lengths (large or small).  
Specify number of tiers.  
Additional weight support recommended for junction box installation.  
Indoor use and dry locations only.

### Dimensions

Tier length options:  
Large tier: 90" (229 cm)  
Small tier: 59" (150 cm)  
Ceiling mount diameter: 5" (13 cm)  
Minimum overall height:  
14.5" (37 cm)  
Fixture height: 11.5" (29 cm)



# David Weeks Studio